

the SAWGRASS

Plan Options

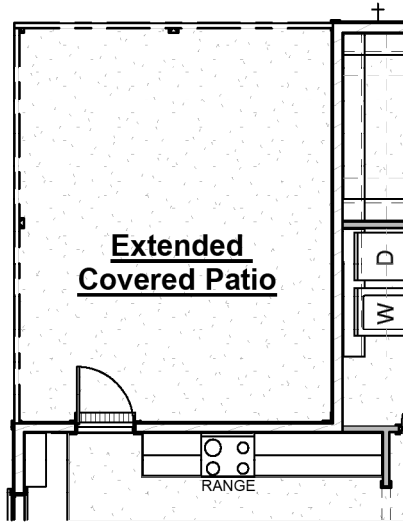

Covered Patio Extension

-Adds 83 sf of additional covered patio

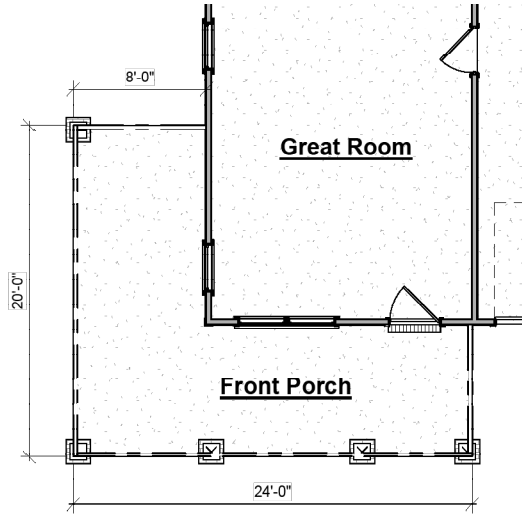

Wrap Around Front Porch

-Adds approximately 160 sf covered porch

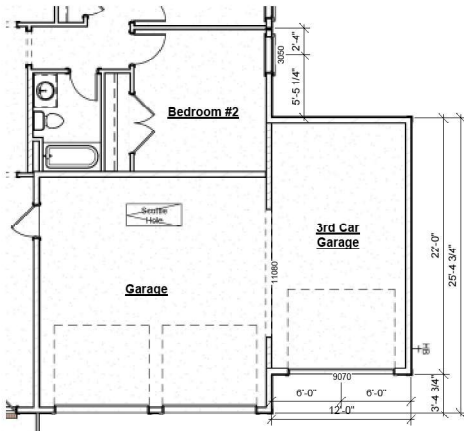

3rd Car Garage

-Adds approx. 253sf to garage
-Adds additional garage door

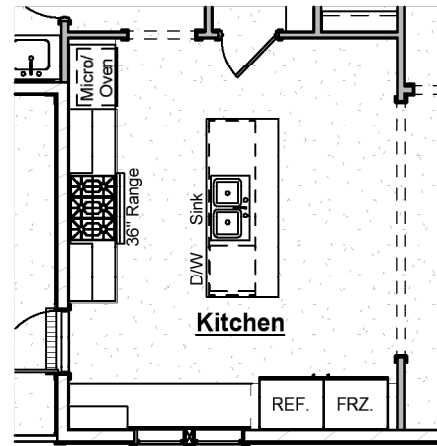

Gourmet Kitchen

-Includes Frigidaire 36" Professional slide-in range, wood hood, 1 wall oven with microwave above, dishwasher, built-in refrigerator & freezer
-Please see additional Gourmet Kitchen Structural Option sheet



Floor Plan Exclusively Designed for the SweetBay Community

the SAWGRASS

Plan Options

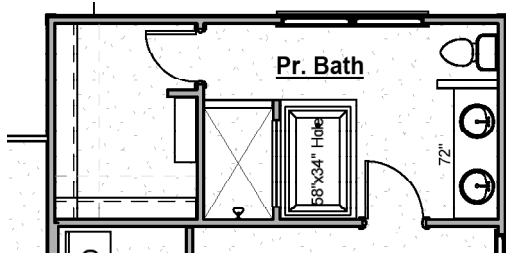

Primary Bathroom Tub

- Adds tub with selection at design
- Reduces shower size to accommodate tub

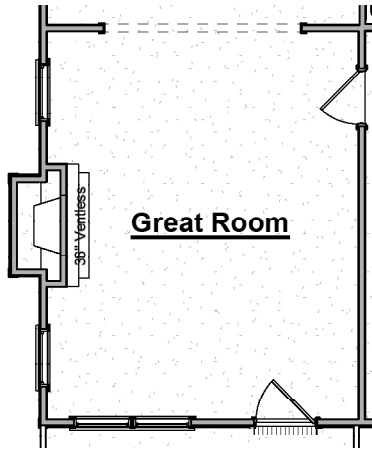

Great Room Fireplace Bump-Out

- Adds fireplace to Great Room
- Includes trim-built mantel, firebox, 18" gas logs, tile surround & electrical outlet above fireplace

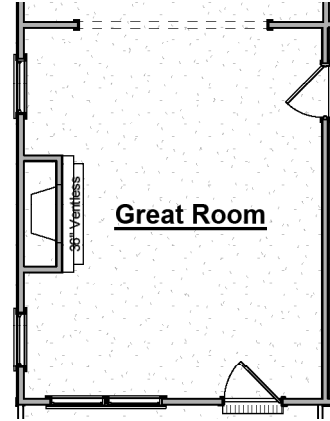

Great Room Fireplace Bump-In

- Adds fireplace to Great Room
- Includes trim-built mantel, firebox, 18" gas logs, tile surround & electrical outlet above fireplace

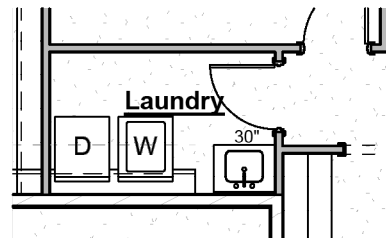

Laundry Room Sink Option

- Includes stainless sink with 30" base cabinet, cabinet hardware and countertop
- Cabinet base and countertop can be replaced with a freestanding utility sink

Other Options

- Garage Utility Sink
- Guest Bath Syn-Iron Tub Shower with Tile Surround
- Pedestal Tubs

*Certain structural options may not be available due to lot restrictions and/or selection of other options. Prices subject to change without notice.



HARRISDOYLE.COM



facebook.com/harrisdoylehomes



@harrisdoylehomes
#harrisdoyle



HARRIS DOYLE
HOMES

