

# the GRAYTON

## Plan Options

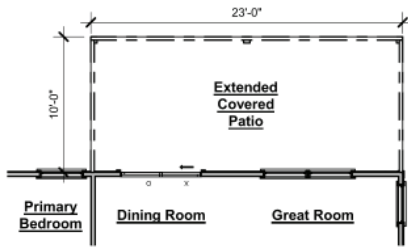

*Covered Patio Extension*

-Adds 130 sf of additional covered patio

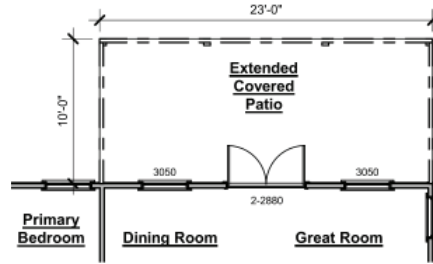

*Covered Patio Extension with Double Doors*

-Adds 130 sf of additional covered patio  
-Includes double doors to patio & relocates window location from original layout

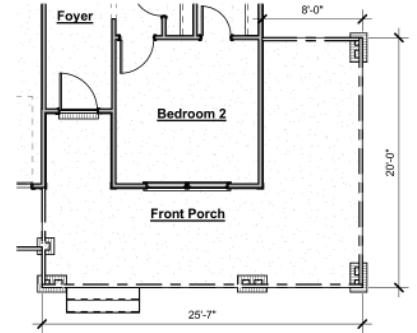

*Wrap Around Front Porch*

-Adds approximately 160 sf covered porch

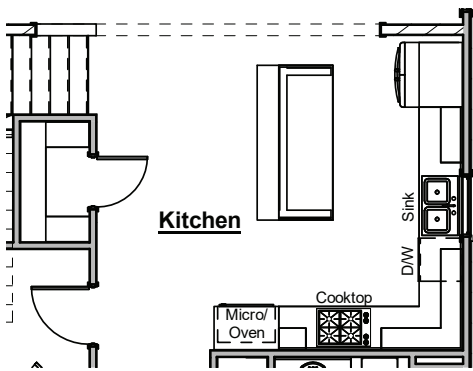

*Chef's Kitchen*

-Includes Frigidaire Gallery cooktop, wood hood, microwave above wall oven, dishwasher & cabinets in island



*Primary Bathroom Tub*

-Adds drop-in tub with tile surround  
-Reduces shower size to accommodate tub



*Great Room Fireplace Bump-In*

-Adds fireplace to Great Room  
-Includes trim-built mantel, firebox, 18" gas logs, tile surround & electrical outlet above fireplace



**HARRIS DOYLE**  
HOMES

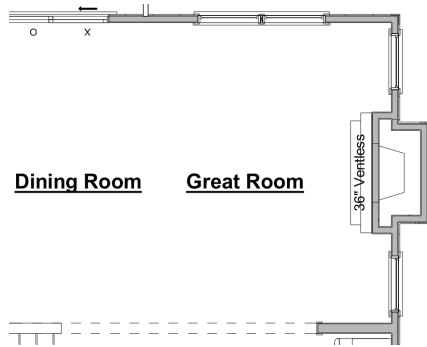

*Great Room Fireplace Bump-Out*

- Adds fireplace to Great Room
- Includes trim-built mantel, firebox, 18" gas logs, tile surround & electrical outlet above fireplace

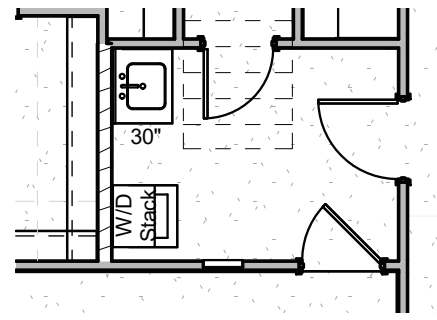

*Laundry Room Sink Option*

- Includes stainless sink with 30" base cabinet, cabinet hardware and countertop
- Cabinet base and countertop can be replaced with a freestanding utility sink
- Does not include stacking kit for washer & dryer

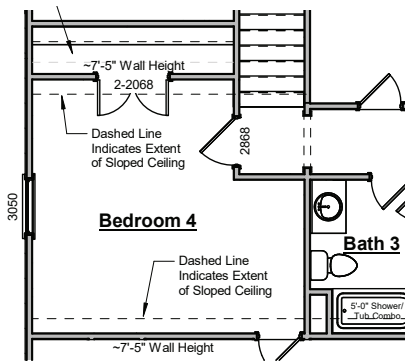

*4th Bedroom*

- Adds 4th bedroom option in lieu of Loft on 2nd floor

*Other Options*

- Garage Utility Sink
- Guest Bath Syn-Iron Tub Shower with Tile Surround
- Pedestal Tubs

*Bayside*

\*Certain structural options may not be available due to lot restrictions and/or selection of other options. Prices subject to change without notice.



**HARRIS DOYLE**  
HOMES



**LIFE WELL CRAFTED**



HARRISDOYLE.COM



facebook.com/harrisdoylehomes



@harrisdoylehomes  
#harrisdoyle